

VALVULA DE BOLA 3-VIAS CON BRIDA

Material: A° carbono ASTM A216 WCB/Steel ASTM A216 WCB
Acero inoxidable CF8M/Stainless steel CF8M

Paso total/Full Bore

Paso en "L" o en "T" / L or T Port

Estanca en las 3 vías / Tightness on 3 ways

Dispositivo de bloqueo /Locking device

Medidas/Size: DN-50 a DN-150

Temperatura/Temperature: -30°C +150°C in St.Steel
-20°C +150°C in Carbon steel

Presión max./Max.Pressure: 16 Bar

Placa de montaje/Mounting pad: ISO5211

Asientos/Seats: PTFE con fibra de vidrio
PTFE with glassfiber



Item	Designation	Carbon Steel	Stainless Steel
1	Body	ASTM A216 WCB	ASTM A351 CF8M
4	Ball	ASTM A351 CF8	ASTM A351 CF8M
5	Stem	SS 304	SS 316
9	Ends	ASTM A216 WCB	ASTM A351 CF8M
10	Blind cap	ASTM A216 WCB	ASTM A351 CF8M
11'	Body seal	PTFE	
12'	Seat	PTFE filled with 15% glass	
13'	Thrust washer	PTFE	
14'	Stem packing	PTFE	
15	Gland	SS 304	
19-	Handle	Iron	
22	Stem nut	SS 304	
23	Handle washer	SS 304	
29	Elastic washer	SS 410	
30	Stop washer	SS 304	
31'	O ring	FKM	
32'	Packing follower	PTFE filled with 15% grafoil	
33	Stop pin	SS 304	
35	Bolt washer	SS 304	
36	Bolt	SS 304	
50	Handle adapter	ASTM A351 CF8	

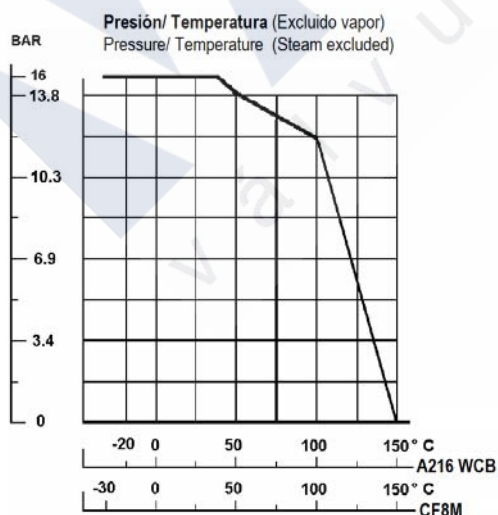
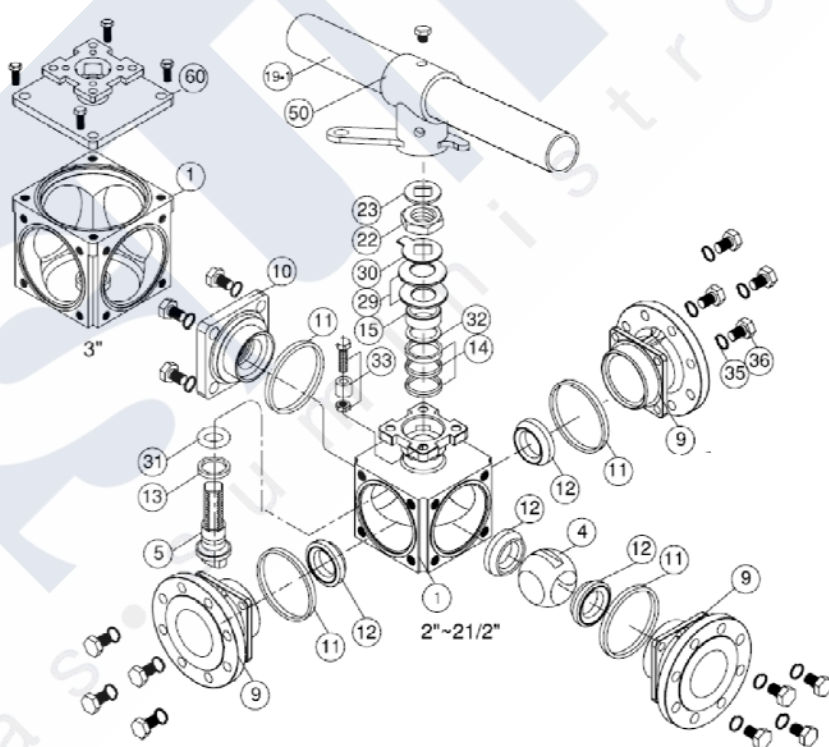

Paso en "L" / L Port

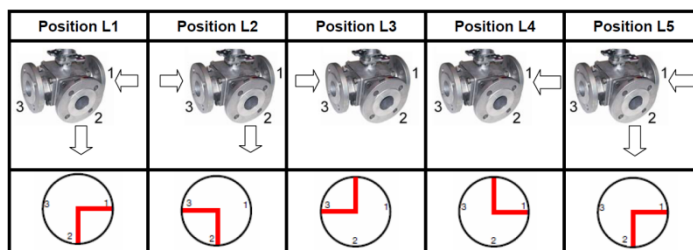

Paso en "T" / T Port

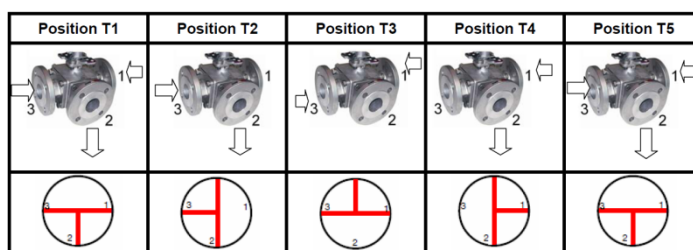

DN 50 - 80

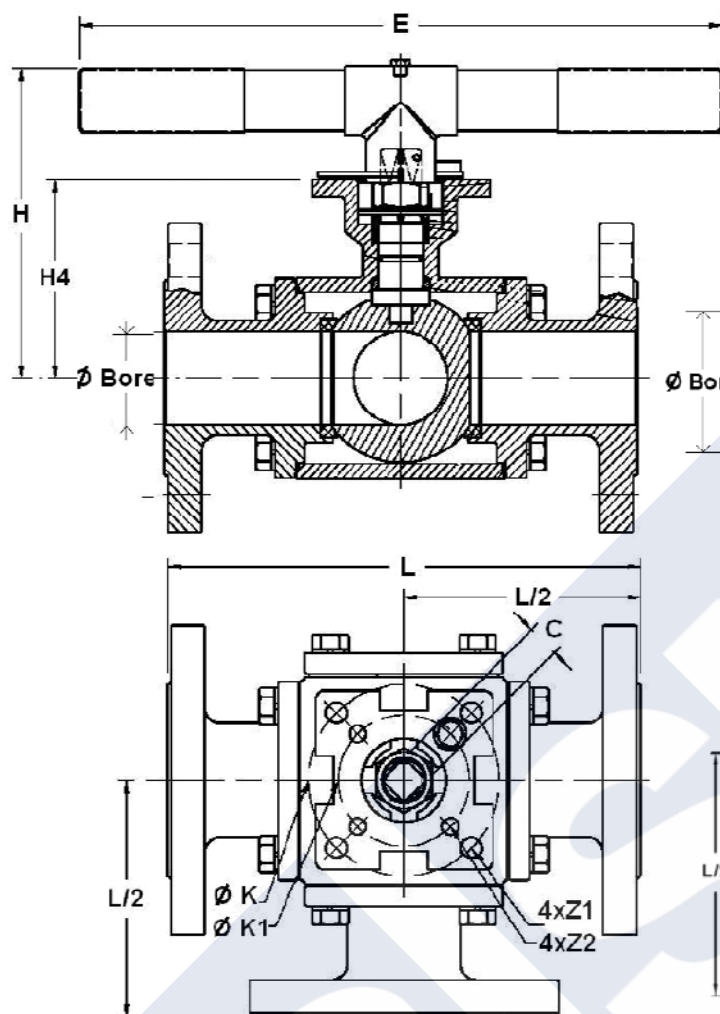

DN 100 - 150

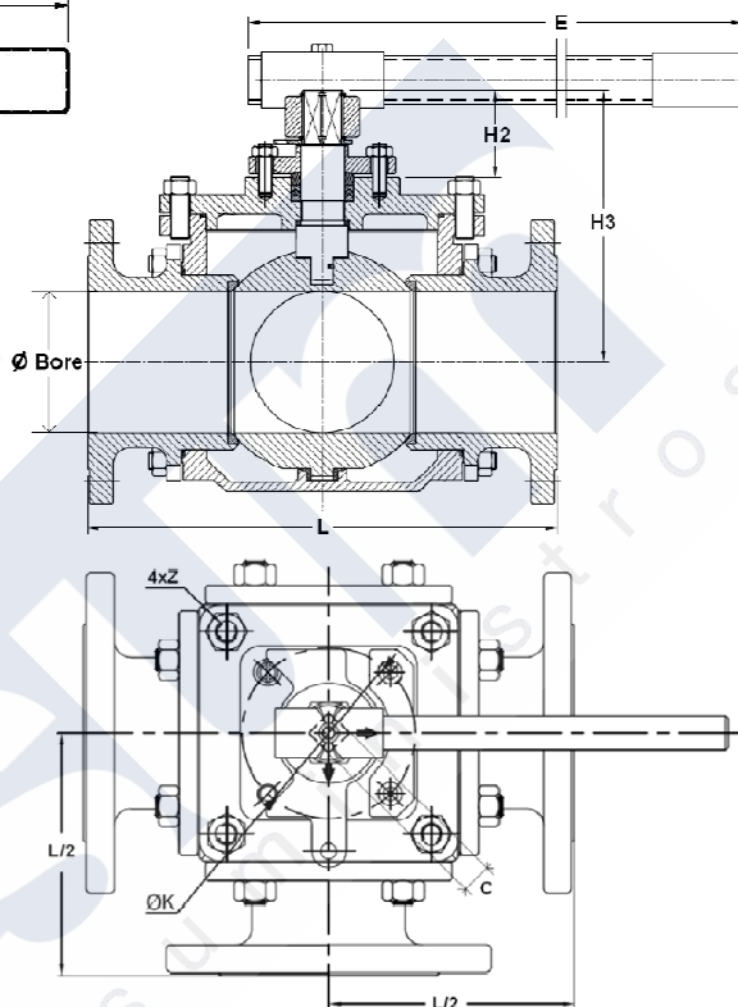

DN	50	65	80
Ø Bore	49	64	76
L	253	278	292.2
L/2	126.5	139	146.1
E	300	300	300
H	156.6	168.85	178
H1	17.8	17.5	17.5
H4	105.8	117.3	128
C	17	17	17
Ø K	102	102	102
ISO	F10	F10	F10
Ø K1	70	70	70
ISO	F07	F07	F07
4xZ1	4x11	4x11	4x11
4xZ2	4x9	4x9	4x9
Weight (Kg)	19	23.75	34.5

DN	100	125	150
Ø Bore	99	125	150
L	360	416	473
L/2	180	208	236.5
E	600	600	800
H1	33	33	43.5
H2	70	70	77.5
H3	193	233	266
C	27	27	36
Ø K	125	125	140
ISO	F12	F12	F14
4xZ	4x12	4x12	4x16
Weight (Kg)	67.4	95	124